

120-MW-12

FEATURES:

- SIZE: 12" DIAMETER SKIRT OPENINGS SELF ALIGNING COVER AND BOLT HOLES FOR EASE OF INSTALLATION AND REMOVAL
- DUCTILE CAST IRON FRAME AND COVER
- 14 GAUGE CARBON STEEL SKIRT 24" DEPTH
- API TRIANGULAR SYMBOL AND THE WORDS "MONITORING WELL" AND "DO NOT FILL" CAST INTO COVER
- STAINLESS STEEL HEX HEAD BOLTS SECURE COVER FOR LIMITED ACCESS AND UNAUTHORIZED PRODUCT DROPS BUNA-N GASKET FORMS WATERTIGHT SEAL PREVENTING RUN-OFF CONTAMINATION
- ALL STEEL IS COATED WITH PROTECTED PAINT

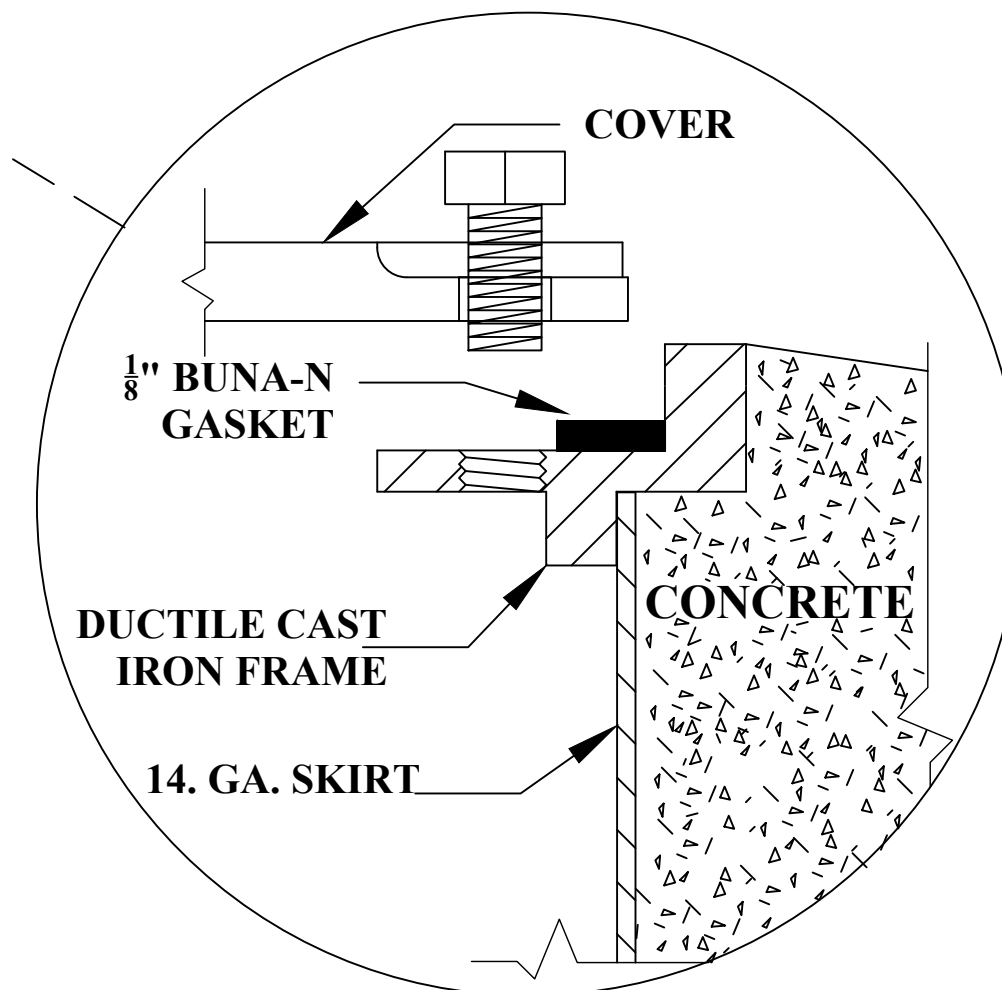
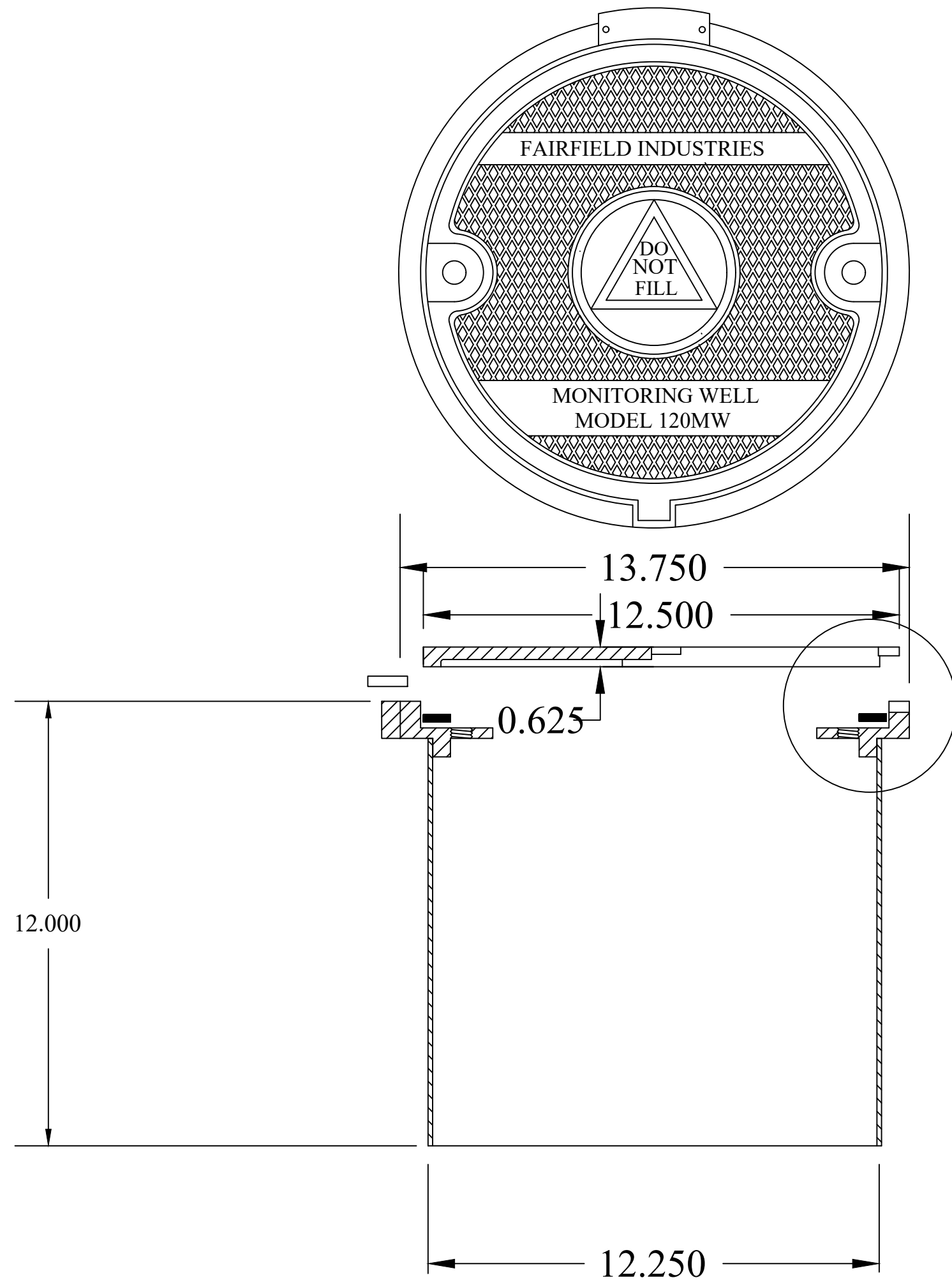

DO NOT SCALE DRAWING
 UNLESS OTHERWISE SPECIED
 DIMENSIONS ARE IN INCHES.
 TOLERANCES ON ANGLES: $\pm 1^\circ$
 FRACTIONAL: $\pm 1/16$
 2-PLACE DECIMALS: ± 0.062
 3-PLACE DECIMAL: ± 0.032

FAIRFIELD INDUSTRIES, INC
 4483 CHOPPEE ROAD, GEORGETOWN SC 29440
 PHONE: 843-461-3894 FAX: 843-461-3907

DESCRIPTION				REV.
120-MW-12				1
SIZE	SCALE	DWG.NO.		
C	NTS	D062921-5		
DRAWN BY		DATE	SHT.	
D NETTLES		06/29/21	1 OF 1	

This document is proprietary and confidential. No part of this document may be disclosed in any manner to a third party without the prior written consent of Fairfield Industries

THIRD ANGLE PROJECTION

