

REAR

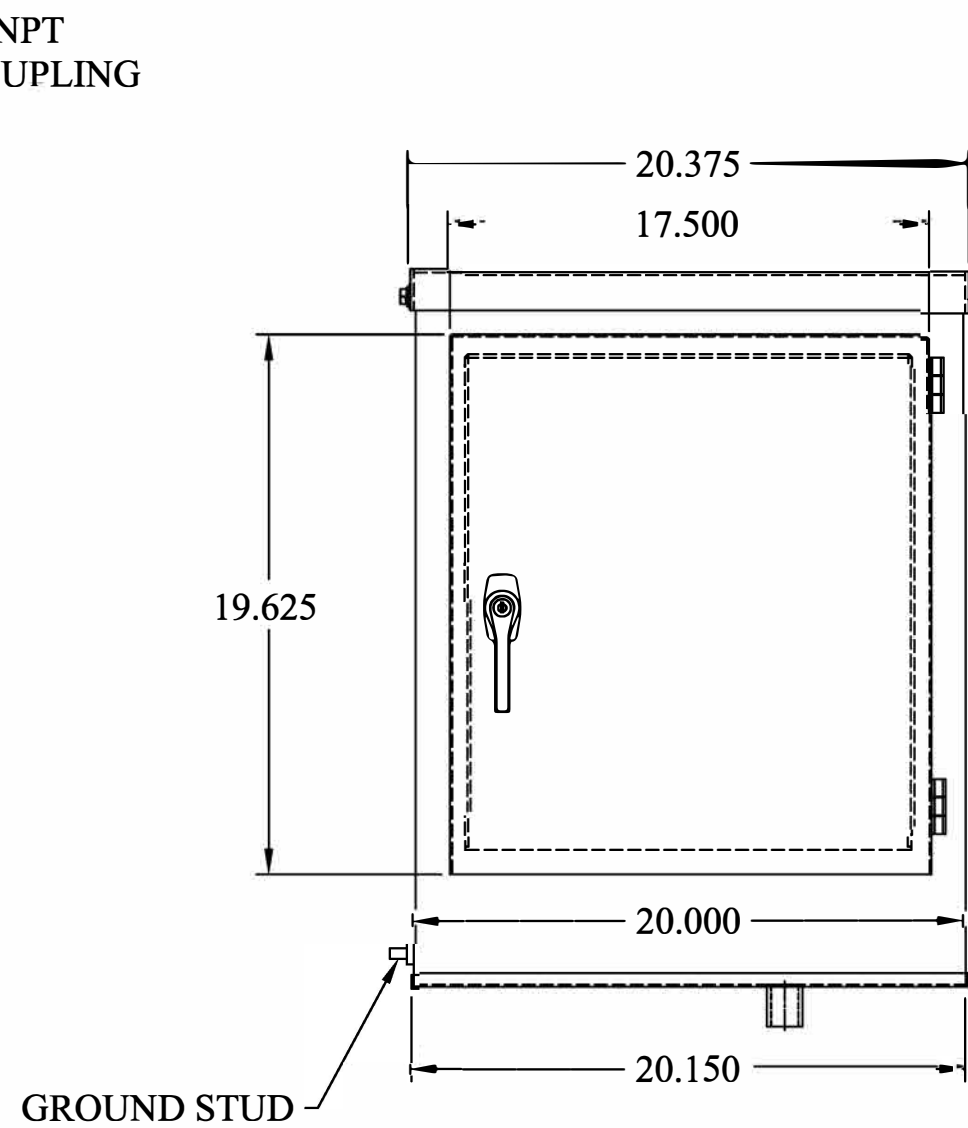

FRONT

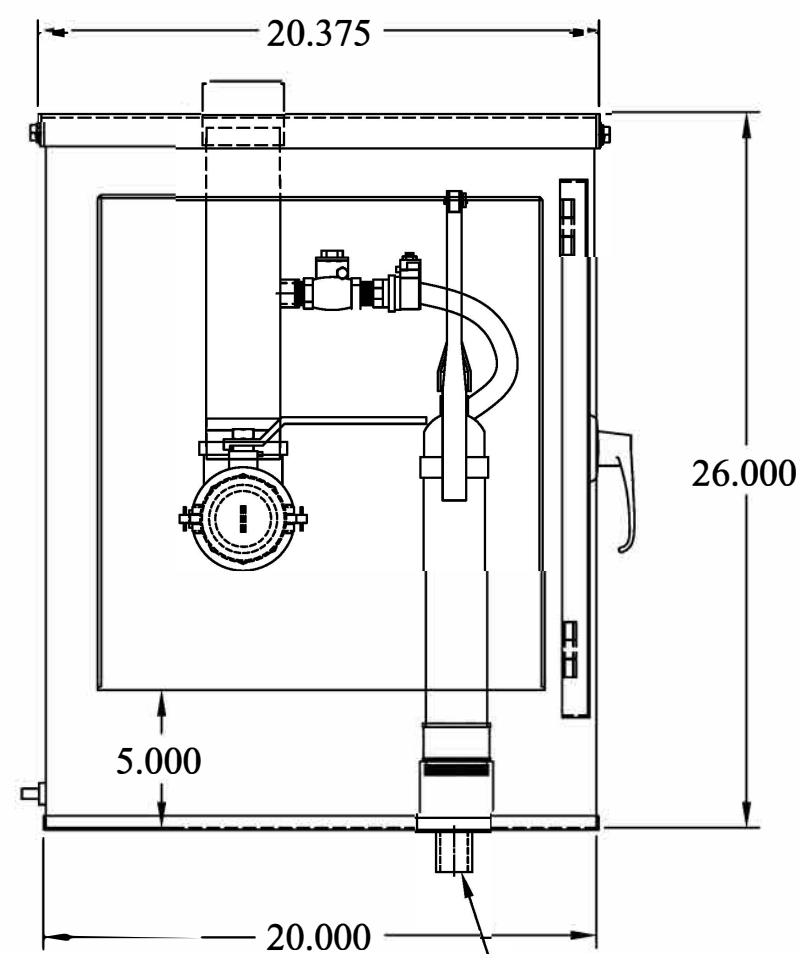

FRONT DOOR OPEN
DRAIN FITTING

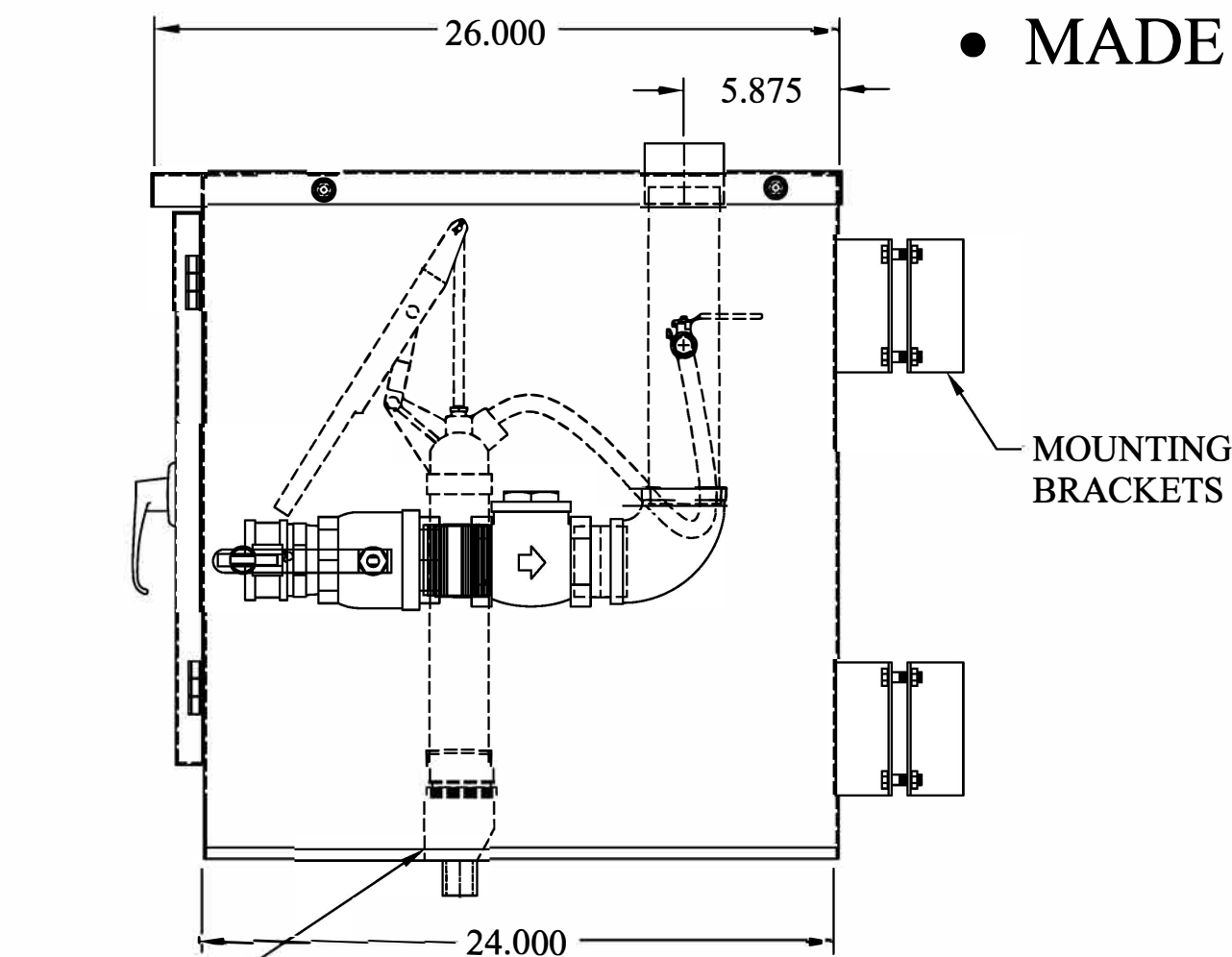

RIGHT SIDE
RIGHT SIDE
DRAIN FITTING

FEATURES:

- HEAVY GAUGE CARBON STEEL ENCLOSURE, ALL WELDED CONSTRUCTION
- 14 GAUGE CARBON STEEL LOCKABLE HINGED DOOR
- ONE (1) 2" NPT TOP OUTLET
- 10 GALLON SPILL CONTAINMENT
- HAND PUMP W/ CHECK VALVE AND SHUTOFF
- INLET CONNECTIONS W/ QUICK CONNECTORS AND DUST CAPS
- INTERNAL PRE-PLUMBED CHECK VALVES, FITTINGS AND SHUTOFF VALVES
- ONE(1) GROUND STUD
- TWO (2) MOUNTING BRACKETS (FOR 3" PIPE)
- VENT LOCATED UNDER FRONT DOOR
- POWDER COATED WHITE
- MADE IN USA

This document is proprietary and confidential. No part of this document may be disclosed in any manner to a third party without the prior written consent of Fairfield Industries

DO NOT SCALE DRAWING

UNLESS OTHERWISE SPECIFIED, DIMENSIONS ARE IN INCHES.

TOLERANCES ON ANGLES: $\pm 1^\circ$
 FRACTIONAL: $\pm 1/64$
 2-PLACE DECIMALS: ± 0.05
 3-PLACE DECIMALS: ± 0.005

THIRD ANGLE PROJECTION

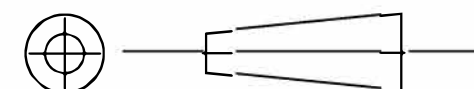

FAIRFIELD INDUSTRIES, INC

4483 CHOPPEE ROAD, GEORGETOWN SC 29440

PHONE: 843-461-3894 FAX: 843-461-3907

DESCRIPTION

ARFPC-2-TOP

SIZE C	SCALE NTS	DWG. NO D011518-2	C.REV -	REV 1
DRAWN BY D. NETTLES		DATE 01/04/20	SHT 1 OF 1	