

**REMOTE FILL PORT, STAINLESS STEEL**

**FEATURES:**

- 14 GA STAINLESS STEEL, ALL WELDED CONSTRUCTION
- 20 GALLON SPILL CONTAINMENT
- HINGED PAD LOCKABLE DOOR
- TWO (2) FLEXIBLE ENTRY FITTINGS(2, 3, 4")
- ONE (1) 0.750" NPT DRAIN CONNECTION
- MADE IN USA

This document is proprietary and confidential. No part of this document may be disclosed in any manner to a third party without the prior written consent of Fairfield Industries

**DO NOT SCALE DRAWING**  
UNLESS OTHERWISE SPECIFIED, DIMENSIONS ARE IN INCHES.  
TOLERANCES ON ANGLES: ± 1°  
FRACTIONAL: ±1/64  
2-PLACE DECIMALS: ± 0.05  
3-PLACE DECIMALS: ± 0.005

THIRD ANGLE PROJECTION

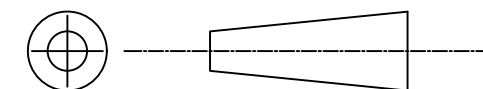

**FAIRFIELD INDUSTRIES, INC**

4483 CHOPPEE ROAD, GEORGETOWN SC 29440  
PHONE: 843-461-3894 FAX: 843-461-3907

DESCRIPTION **RFP-2 PORT**

SIZE <b>C</b>	SCALE <b>NTS</b>	DWG. NO <b>S071917-1</b>	C.REV <b>1</b>	REV <b>1</b>
DRAWN BY <b>S BESHORE</b>		DATE <b>07/19/17</b>	SHT <b>1 OF 5</b>	